



Homed:In

18 Station Road, Southwater, RH13 9HQ



Kennard Crescent

Southwater, Horsham, RH13 9FH

Offers Over £495,000

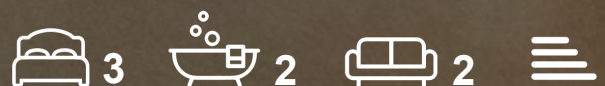

Kennard Crescent



Description

A striking nearly new build home with big double bedrooms, set in the heart of picturesque Southwater.

- Stunning New Build
- Built by Berkeley Homes in 2020 to High Specification
- Top Floor Bedroom Offers Expansive Space, Ideal for 4th Bedroom
- Spanning 1,500 Sq Ft of Open Space
- Unbeatable Downs Link Location for Walks
- Quiet, Safe Cul de Sac Ideal for Children/Pets
- Premium Quality Finish Throughout
- Unmatched Privacy via 3 Storeys
- Reserved Parking for TWO Cars
- A Stunning Example - Enquire Today





Floor Plan

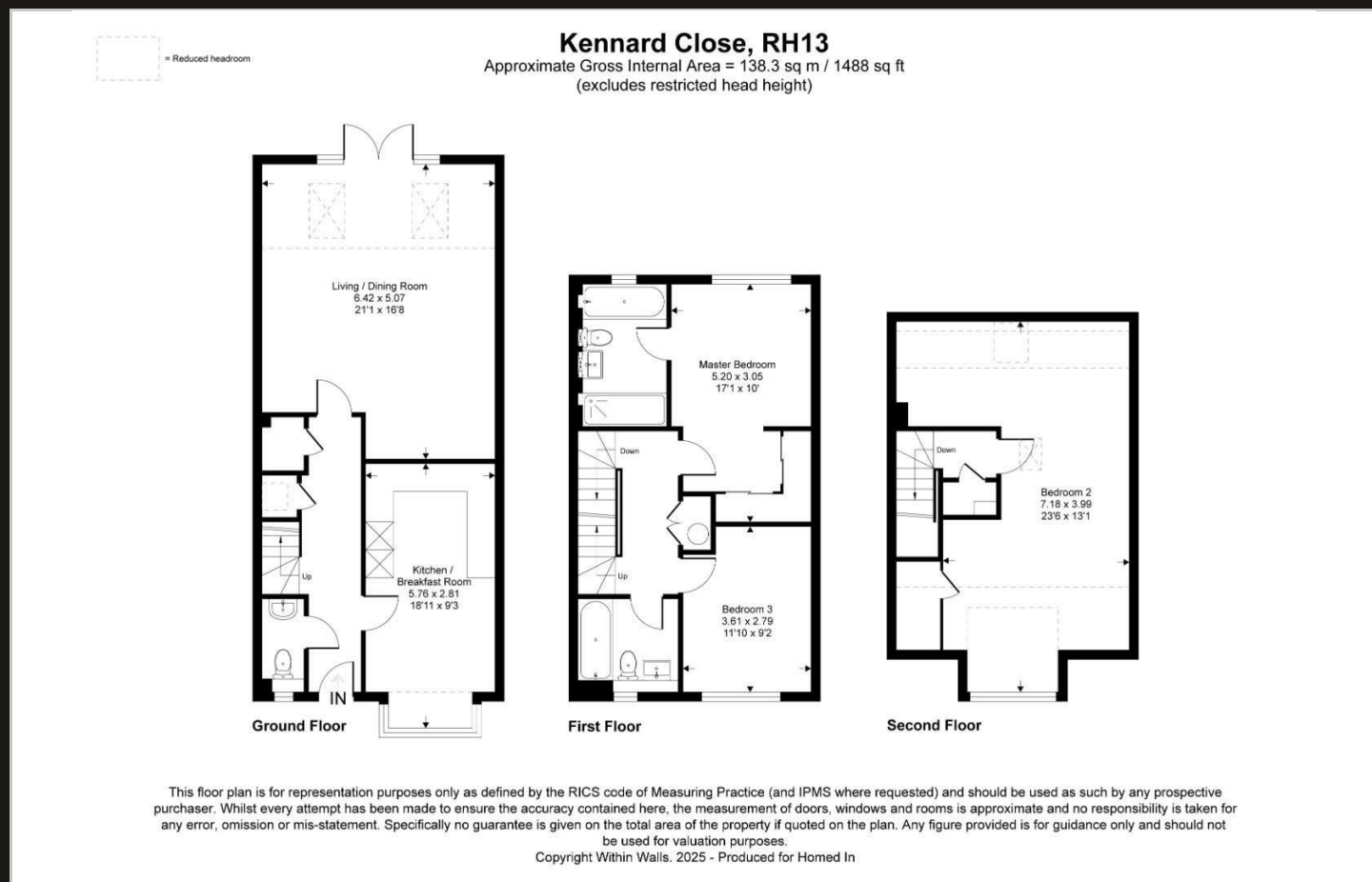

Area Map

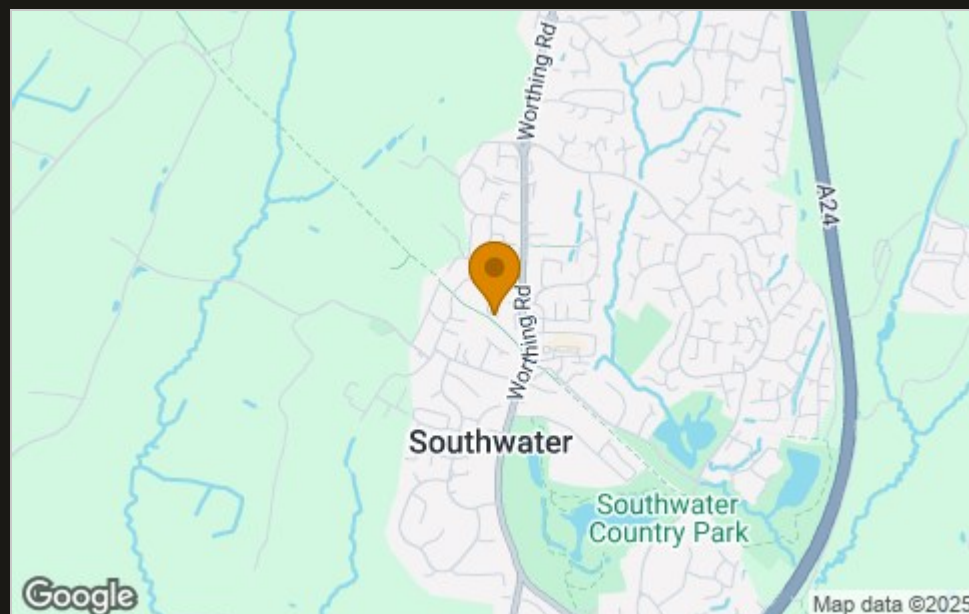

Viewing

Please contact our Horsham Office
on 01403 597595 if you wish to arrange a viewing appointment for this property
or require further information.

These particulars, whilst believed to be accurate are set out as a general outline only for guidance and do not constitute any part of an offer or contract. Intending purchasers should not rely on them as statements of representation of fact, but must satisfy themselves by inspection or otherwise as to their accuracy. No person in this firm's employment has the authority to make or give any representation or warranty in respect of the property.

Energy Efficiency Graph

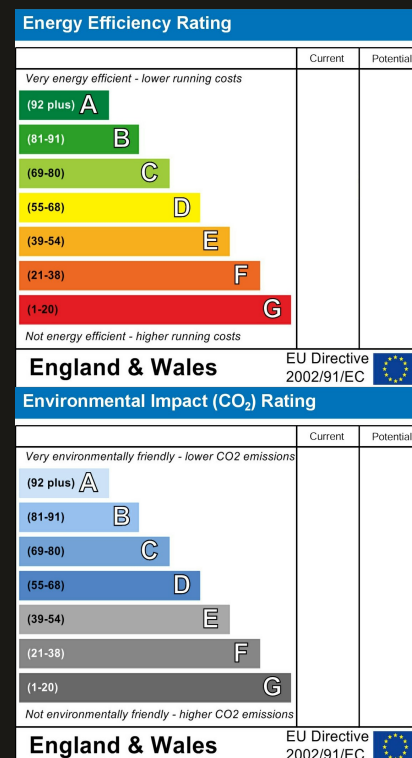

To **GET A FREE VALUATION** Call us on: **01403 597595**
or email us at: **info@homedin.co.uk**